

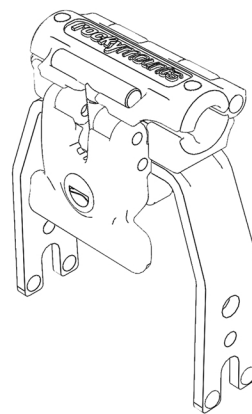

rockymounts™
DriveShaft



Guidelines

This adapter is for use on fork mount bike carriers.

Compatible with 12mm, 15mm & 20mm thru axles (up to 10mm wide).

Weight limit: 35 lbs.

Do not exceed the load capacity of your vehicle's roof rack or bike carrier.

Do not use on tandem bicycles.

Clamping force prevents thru axle from being removed thus locking the bike.

Parts Included

A: Body w/ 15mm Plastic Shims

B: 12mm Plastic Shim

C: Key

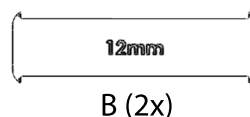
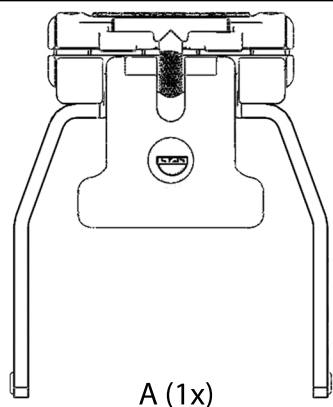

Installation Instructions

1 Install Adapter

Method 1: attach adapter's fork ends to QR skewer with handle facing forward. Secure adapter with QR

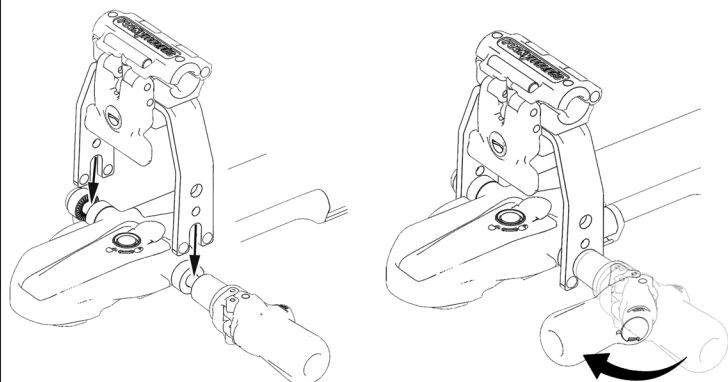

1 Install Adapter

Method 2: with handle facing forward, align upper holes of adapter with QR holes on bike carrier. Install QR skewer through holes. Secure adapter with QR

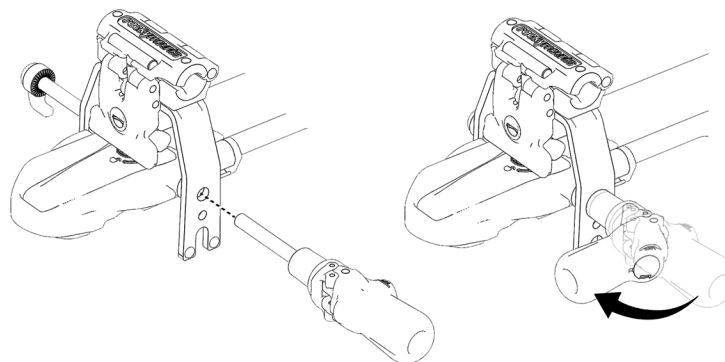

Installation Instructions

2 Axle Selection

Unlock and lift handle. Pull back T-bolt and open top cap. Pre-installed shims are for 15mm axles. For 12mm axles, switch to blue shims. For 20mm axles, remove shims. Rotate T-bolt in place and close top cap when not in use

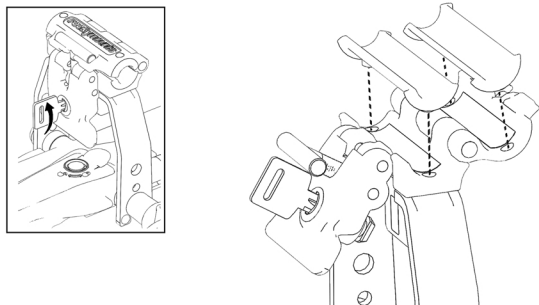

3 Load Bicycle

Remove front wheel from bike and reinstall axle. Open top cap, load axle into opening and close top cap. Rotate T-bolt into place and close handle. Handle should close with tension. If too tight or too loose, open handle and adjust T-bolt until handle closes with tension. Shake fork side to side to ensure secure mounting. Insert key and lock adapter

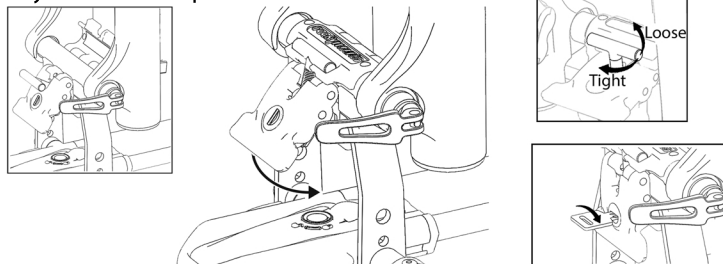

4 Test Fit: Rotation Interference

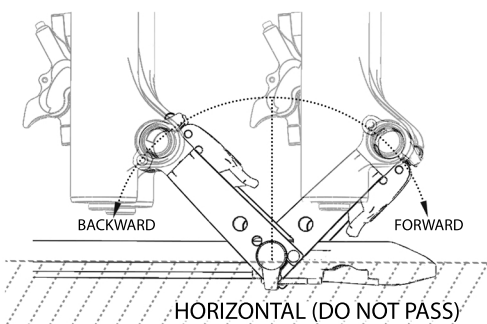

After mounting your bike, rotate adapter both forward and back until it stops. If any of the following conditions exist, the warranty is void and use is at your own risk:

- Adapter rotates more than 180°
- Adapter, fork legs, suspension adapters, or disc brake contacts the vehicle or glass in any position
- There are objects, interference or protrusions that can push the handle open in any position
- Fork legs, suspension adjusters, or disc brake contacts the adapter in any position

Warnings

Thru-axle adapters can rotate while driving. Use of a second rear wheel strap, approximately 4-5" apart will solve this. Additional wheel strap not included.

Check all fastenings (nuts, bolts, straps, and QR skewers) before each use.

After loading bike, shake fork side to side to ensure proper mounting. If at all unsure, do not use.

Remove Baby Seats, Panniers, U-Locks (items that could detach from the bicycle).

Do not use bicycle covers or bicycle bras.

Not intended for off road use. Not intended for use on trailers or towed vehicles.

Locks are only deterrents to thieves, RockyMounts™, Inc. cannot be held liable for stolen bicycles.

Remove bicycles before entering a car wash.

Periodically lubricate threads on T-bolt.

Inspect and replace if damaged or rusting.

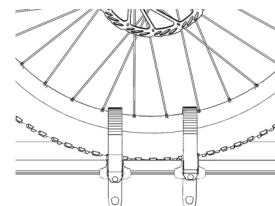

Lifetime Warranty

Thank you for purchasing a RockyMounts™ product. We take pride in providing a great customer experience and manufacturing products that enable our customers to get their gear to their next colorful adventure.

As of January 1, 2014, RockyMounts™ products are covered for life to the original purchaser when used in accordance with the instruction manuals' assembly, installation and use guidelines.

If you feel something broke before it's time, please email us at ride@rockymounts.com or call us at 800.873.1871. For the most efficient service, email a digital photo (we need this photo to verify the problem) of the product in question, a brief description of the situation, and your purchase receipt. Our techs will respond within one business day. Most of the time we'll replace the part in question, but we may ask for more details.

RockyMounts™, Inc. warranty only covers RockyMounts™, Inc. products. It does not cover theft, or damage to vehicles and/or equipment.

All products purchased prior to Jan 1, 2014 are covered by a one-year warranty; see your product manual for details.