

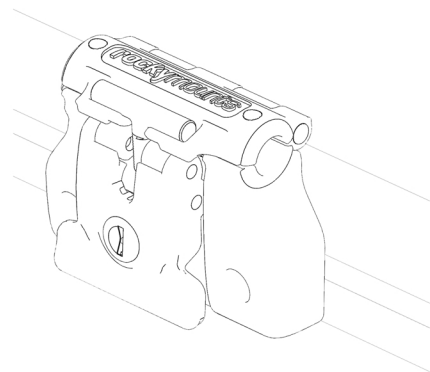

rockymounts™
DriveShaft
Track



Guidelines

This carrier is for 12mm, 15mm & 20mm thru axles (up to 10mm wide) only; standard forks can be carried with the dummy 9mm axle (sold separately).

Bicycle weight limit: 40lbs.

Do not use on tandem bicycles.

This carrier is intended for RockyMounts™, Toyota®, Nissan®, and GMC® tracks only; use on other systems is at your own risk.

Clamping force prevents thru axle from being removed thus locking the bike.

Parts Included

A: Body w/ 15mm Plastic Shims

B: 12mm Plastic Shim

C: Key

D: T30 Torx Key

E: M6 X 25 SHCS Torx Bolt

F: M6 Split Washer

G: M6 Flat Washer

H: Track Plate

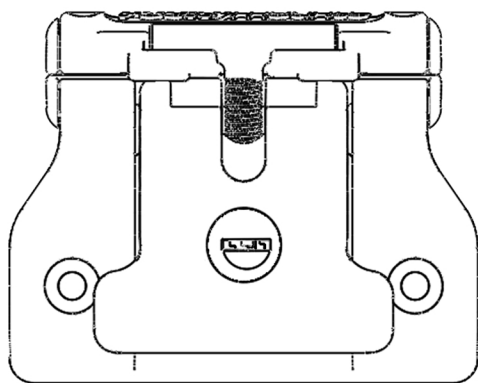

A (1x)



B (2x)

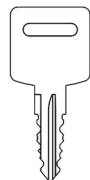

C (2x)

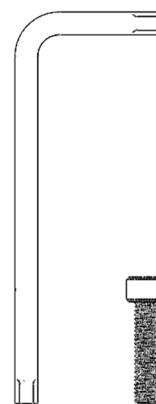

D (1x)



E (3x)



F (3x)



G (3x)



H (3x)

Installation Instructions

1 Install Track Kit

Unlock and lift handle. Pull back T-bolt and open top cap. Place a split washer, then a flat washer onto each bolt. Pass bolts through mounting holes and loosely thread into track plates

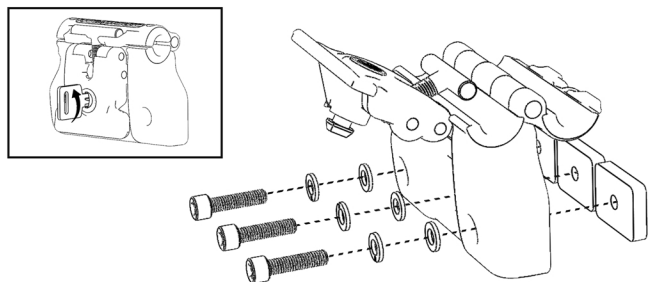

2 Mount Body to Track

Slide assembly onto track from either end. Tighten three bolts using T30 torx key

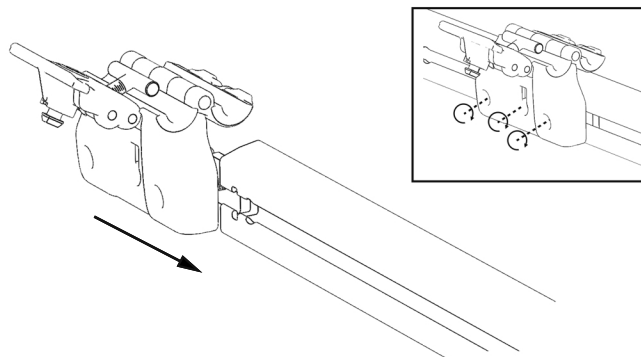

3 Axle Selection

Pre-installed shims are for 15mm axles. For 12mm axles, switch to blue shims. For 20mm axles, remove shims. Rotate T-bolt in place and close top cap when not in use

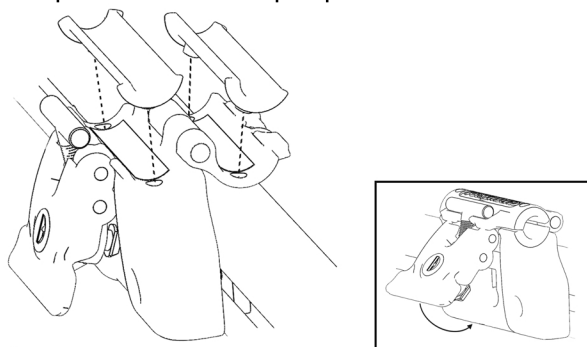

4 Load Bicycle

Remove front wheel from bike and reinstall axle. Open top cap, load axle into opening and close top cap. Rotate T-bolt into place and close handle. Handle should close with tension. If too tight or too loose, open handle and adjust T-bolt until handle closes with tension. Lock handle

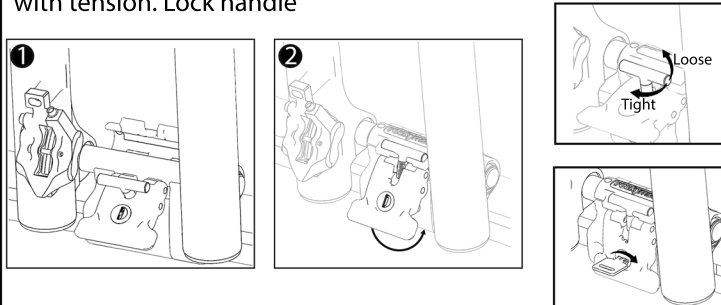

Warnings

Check all fastenings (nuts, bolts, straps, and QR skewers) before each use.
After loading bike, shake fork side to side to ensure proper mounting. If at all unsure, do not use.
Remove Baby Seats, Panniers, U-Locks (items that could detach from the bicycle).
Do not use bicycle covers or bicycle bras.
Not intended for off road use. Not intended for use on trailers or towed vehicles.
Locks are only deterrents to thieves, RockyMounts™, Inc. cannot be held liable for stolen bicycles.
Remove bicycles before entering a car wash.
Periodically lubricate threads on T-bolt.
Inspect and replace if damaged or rusting.

Lifetime Warranty

Thank you for purchasing a RockyMounts™ product. We take pride in providing a great customer experience and manufacturing products that enable our customers to get their gear to their next colorful adventure.

As of January 1, 2014, RockyMounts™ products are covered for life to the original purchaser when used in accordance with the instruction manuals' assembly, installation and use guidelines.

If you feel something broke before it's time, please email us at ride@rockymounts.com or call us at 800.873.1871. For the most efficient service, email a digital photo (we need this photo to verify the problem) of the product in question, a brief description of the situation, and your purchase receipt. Our techs will respond within one business day. Most of the time we'll replace the part in question, but we may ask for more details.

RockyMounts™, Inc. warranty only covers RockyMounts™, Inc. products. It does not cover theft, or damage to vehicles and/or equipment. All products purchased prior to Jan 1, 2014 are covered by a one-year warranty; see your product manual for details.